

# Brainerd Jaycees Run for the Lakes Marathon

USAT&F # \_\_\_\_\_

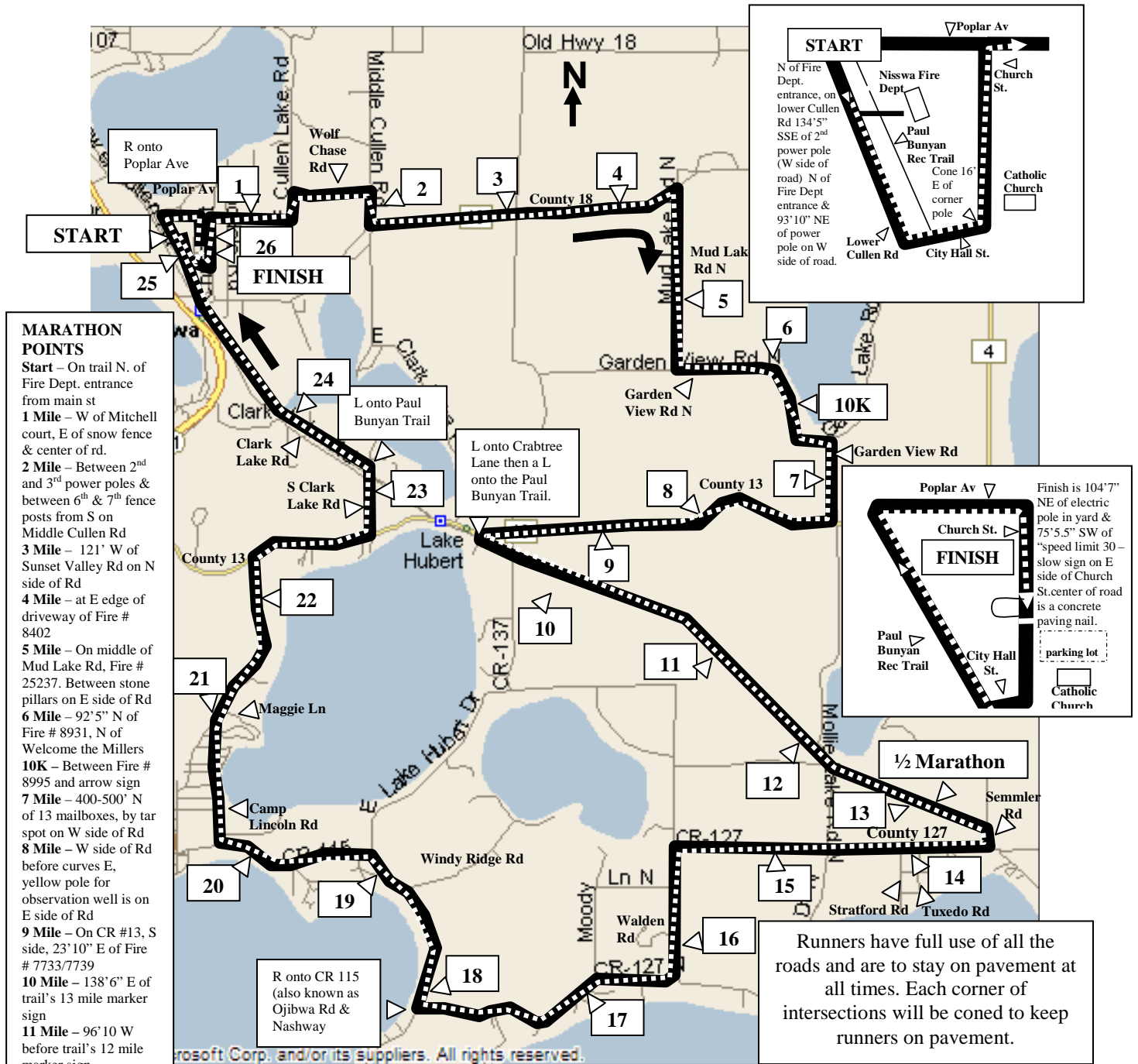

**MARATHON POINTS**  
**Start** – On trail N. of Fire Dept. entrance from main st  
**1 Mile** – W of Mitchell court, E of snow fence & center of rd.  
**2 Mile** – Between 2<sup>nd</sup> and 3<sup>rd</sup> power poles & between 6<sup>th</sup> & 7<sup>th</sup> fence posts from S on Middle Cullen Rd  
**3 Mile** – 121' W of Sunset Valley Rd on N side of Rd  
**4 Mile** – at E edge of driveway of Fire # 8402  
**5 Mile** – On middle of Mud Lake Rd, Fire # 25237. Between stone pillars on E side of Rd  
**6 Mile** – 92' 5" N of Fire # 8931, N of Welcome the Millers  
**10K** – Between Fire # 8995 and arrow sign  
**7 Mile** – 400-500' N of 13 mailboxes, by tar spot on W side of Rd  
**8 Mile** – W side of Rd before curves E, yellow pole for observation well is on E side of Rd  
**9 Mile** – On CR #13, S side, 23' 10" E of Fire # 7733/7739  
**10 Mile** – 138' 6" E of trail's 13 mile marker sign  
**11 Mile** – 96' 10" W before trail's 12 mile marker sign

**12 Mile** – 68' 8" W of trail's 11 mile marker  
**13 Mile** – just E of overhead power lines which go overhead, 32' 7" W from trail's 10 mile marker  
**Half Marathon** – nail on trail's S side, 3/10 mile W of Semmler Road.  
**14 Mile** – N side of Rd, 1/2 way between Tuxedo Rd and Stratford Rd, W of S fenceline  
**15 Mile** – S side of CR 127, W of Fire # 8957  
**16 Mile** – S of Walden Rd, 30' 2" N of mail box 8185  
**17 Mile** – Across from Sullivan's Campground

& Resort, 46' 3" from  
**18 Mile** – 39' 7" NW of pole at intersection of CR 127 and CR 115  
**19 Mile** – 50' 1" N of telephone box, past Fire #7408/7410, by driveway  
**20 Mile** – S of Fire # 5669, 26' 6" S of 10K mark  
**Final 10K** – 9' 6" SE of Fire #5669  
**21 Mile** – on Camp Lincoln Rd, approx 150' before Maggie Lane  
**22 Mile** – E side of Rd, curve before CR 13  
**23 Mile** – S of Fire #24114, W side of Rd,

74' 9.5" NW of speed limit 30 sign  
**24 Mile** – 27' S of culvert on E side of path  
**25 Mile** – 21' 3" N on trail of city park sign, E of wood train, S of city park entrance  
**26 Mile** – 56' 4" N of manhole on Church St & N of Fire # 25837  
**Finish** – Center of Rd, W of Catholic Church parking lot, 104' 7" NE of elect. pole & 75' 5.5" SW of speed limit 30/slow school sign.

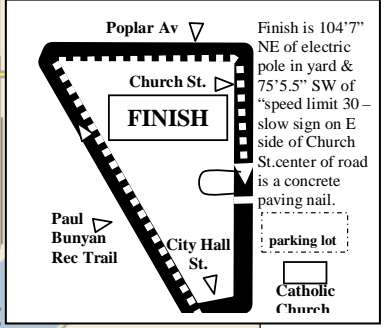
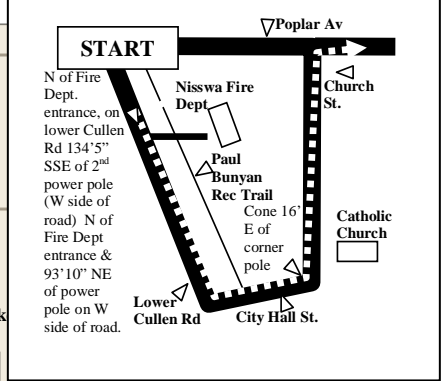

Runners have full use of all the roads and are to stay on pavement at all times. Each corner of intersections will be coned to keep runners on pavement.